



Tree Schedule			
1	Ash	d=0.15	h=5
2	Dycamora	d=0.2	h=7
3	Ash	d=0.15	h=7
4	Ash	d=0.2	h=9
5	Ash	d=0.5	h=8
6	Elder	d=0.15	h=4
7	Elder	d=0.25	h=6

Survey control			
Stn	Easting	Northing	Height
H1	553633.074	174072.787	0.787
H2	553632.855	174039.712	0.395
H4	553645.250	174068.024	0.505
H4	553628.920	174037.062	7.062
H5	553647.838	174005.908	0.508
H6	553641.994	174045.222	0.492
H7	553641.120	174041.500	0.440
H8	553632.047	174013.747	0.980
RD1	553640.620	174069.411	0.823

© Copyright 2011 Hook Survey Partnership  
The copyright of these Plans and all other content shall remain the property of Hook Survey Partnership and shall not be reproduced in any form without the prior written permission of Hook Survey Partnership. The Plans are for the use of the client and are not to be used for any other purpose.

**Hook Survey Legend**

Hedge Telephone line   
Undergrowth Power line   
Tree Draining   
Dish Contour line 0.4   
Building Survey Station  $\Delta$  H5  
Glass Building Gate   
Open Building Level 118.28  
Ordnance Survey Benchmark  $\Delta$  OSGU  
Foul Drainage RW 100  
Storm Drainage RW 100  
RW 110  
RW 112.75  
RW 114.75

**Abbreviations**

Animal Gull	AG
Air Valve	AV
Corehole	CH
Dish Stop	DS
Cover Level	CL
Earth Rod	ER
Electricity Pole	EP
Pipe Hydrant	PH
Inspection Cover	IC
Invert Level	IL
Lamp Post	LP
Manhole	MH
Marker	MK
Name Plate	RNP
Power Pole	PP
Rain water Pipe	RWP
Road Sign	RS
Rodding Eye	RE
Reinforced Steel Joint	RSJ
Soft Vent Pipe	SVP
Stop Valve	SV
Survey Station	STN
Telegraph Pole	TP
Tree Stump	TS
Trial Hole	TH
Unable To Lift	UTL
Vent Pipe	VP
Water Valve	WW

**Notes**

All trees are identified where possible.  
Species, spread, height and girth are indicative only.

Drainage has been surveyed where found, and traced where possible.

Edges and ridge heights of surrounding buildings have been surveyed where possible.

Ordnance survey data added and shown in orange, per colour 30.

## HOOK SURVEY PARTNERSHIP

Land & Building Surveyors  
[www.hooksurvey.com](http://www.hooksurvey.com)

Project :  
No.58 Spital Street,  
Dartford, Kent, DA1 2DT

Client :  
Drapor Architects

Drawing title  
Topographical Survey

Job No. 015/189	Dwg No. 015/150/01	Revision :
Scale 1:200	Date March 2010	Drawn by D.B.

Grid & Levels related to:  
Pseudo Ordnance Survey Coordinate System  
at a scale of 1:000 based around Stations H1 & H2

Head Office  
Unit 1, Dymow Farm  
Orchard Way  
Dartford, Kent  
DA2 7DR  
Email: [info@hooksurvey.com](mailto:info@hooksurvey.com)  
Tel: 01322 277221

Midlands Office  
54 Stretford Road  
Sharnbrook on 604  
Wetherby, Wetherby  
CV29 4AZ  
Email: [midlands@hooksurvey.com](mailto:midlands@hooksurvey.com)  
Tel: 01939 430046

[www.hooksurvey.com](http://www.hooksurvey.com)

THE SURVEY PARTNERSHIP

REAR OF 56-58 SPITAL ST

REAR OF 56-58 SPITAL DAI 200

H. M. LAND REGISTRY

NATIONAL GRID PLAN TQ 5374  
KENT  
DARTFORD DISTRICT

SECTION X

Scale 1/1250

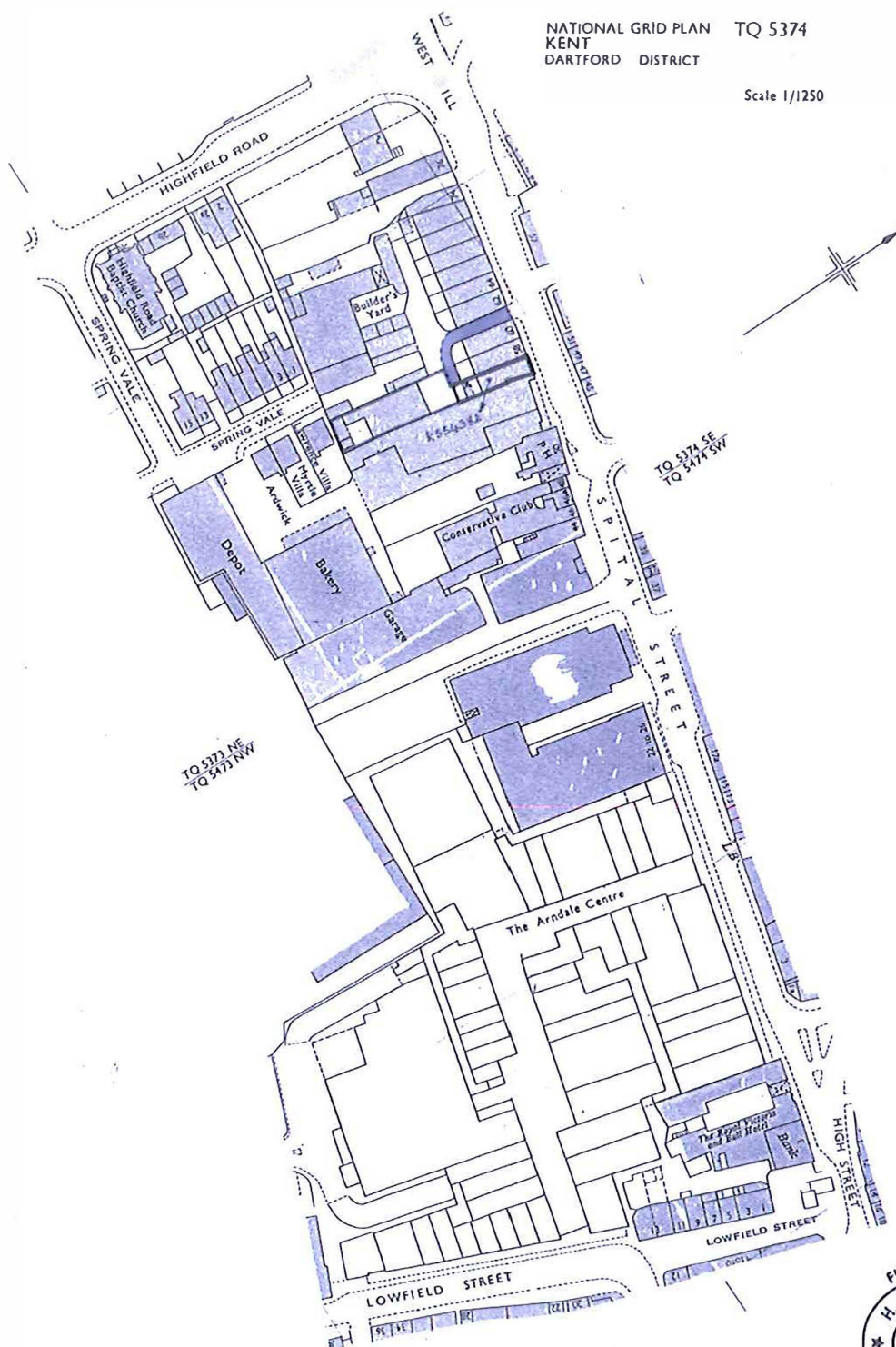

TITLE No. K 34613

© Crown copyright 1980

This is a copy of the title plan on 19 OCT 2016 at 22:18:34. This copy does not take account of any application made after that time even if still pending in the Land Registry when this copy was issued.

This copy is not an 'Official Copy' of the title plan. An official copy of the title plan is admissible in evidence in a court to the same extent as the original. A person is entitled to be indemnified by the registrar if he or she suffers loss by reason of a mistake in an official copy. If you want to obtain an official copy, the Land Registry web site explains how to do this.

The Land Registry endeavours to maintain high quality and scale accuracy of title plan images. The quality and accuracy of any print will depend on your printer, your computer and its print settings. This title plan shows the general position, not the exact line, of the boundaries. It may be subject to distortions in scale. Measurements scaled from this plan may not match measurements between the same points on the ground.

This title is dealt with by Land Registry, Nottingham Office.

© Crown Copyright. Produced by Land Registry. Further reproduction in whole or in part is prohibited without the prior written permission of Ordnance Survey. Licence Number 100026316.

# Land Registry Current title plan

Title number TT27852  
Ordnance Survey map reference TQ5374SE  
Scale 1:1250  
Administrative area Kent : Dartford

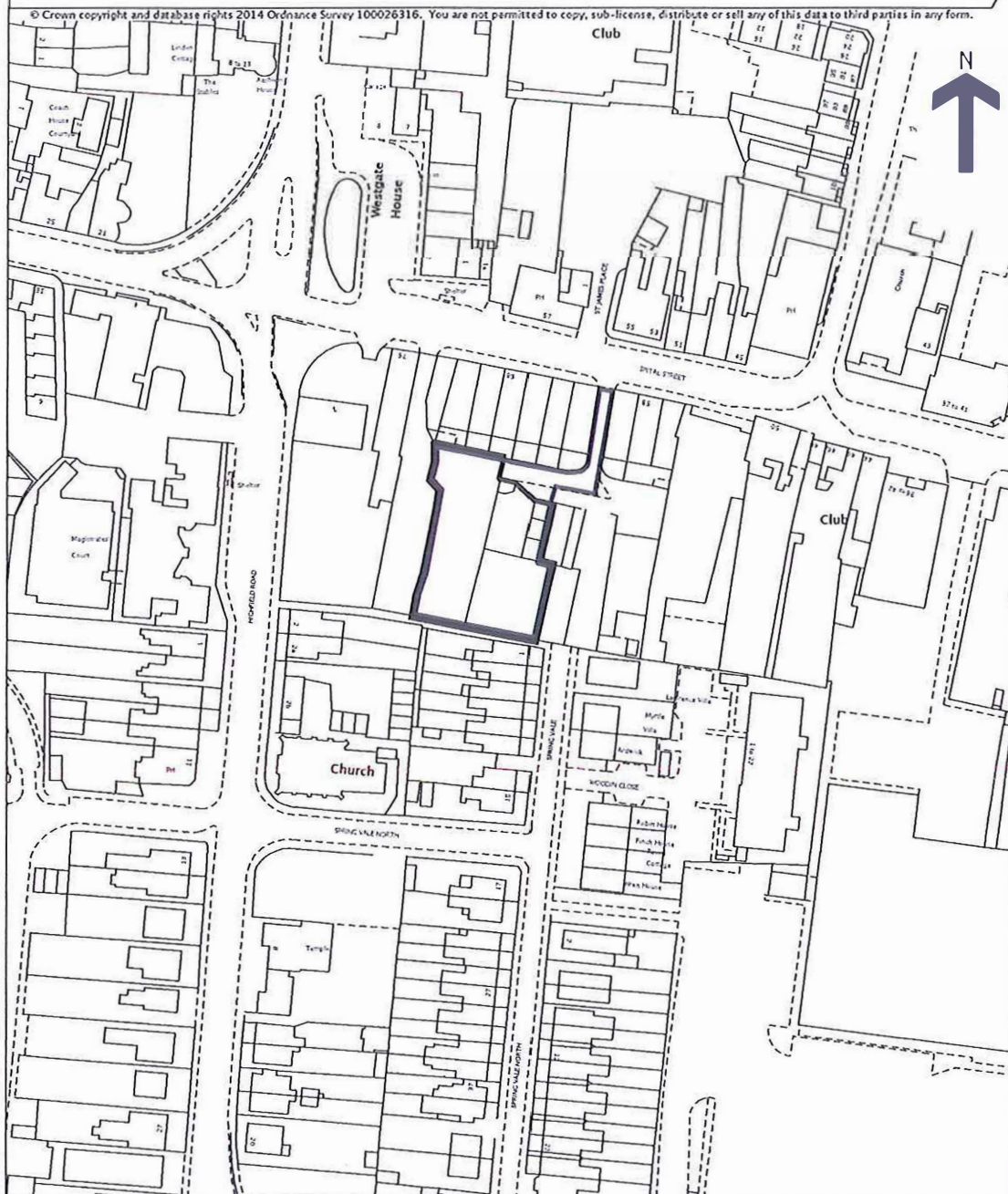
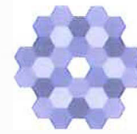

REAR OF 60-72 SPITAL ST  
DARTFORD KENT

This is a copy of the title plan on 18 OCT 2016 at 15:16:32. This copy does not take account of any application made after that time even if still pending in the Land Registry when this copy was issued.

This copy is not an 'Official Copy' of the title plan. An official copy of the title plan is admissible in evidence in a court to the same extent as the original. A person is entitled to be indemnified by the registrar if he or she suffers loss by reason of a mistake in an official copy. If you want to obtain an official copy, the Land Registry web site explains how to do this.

The Land Registry endeavours to maintain high quality and scale accuracy of title plan images. The quality and accuracy of any print will depend on your printer, your computer and its print settings. This title plan shows the general position, not the exact line, of the boundaries. It may be subject to distortions in scale. Measurements scaled from this plan may not match measurements between the same points on the ground.

This title is dealt with by Land Registry, Nottingham Office.

# H. M. LAND REGISTRY

NATIONAL GRID PLAN TQ 5374

SECTION X

(KENT)

DARTFORD PARISH

Scale 1/1250

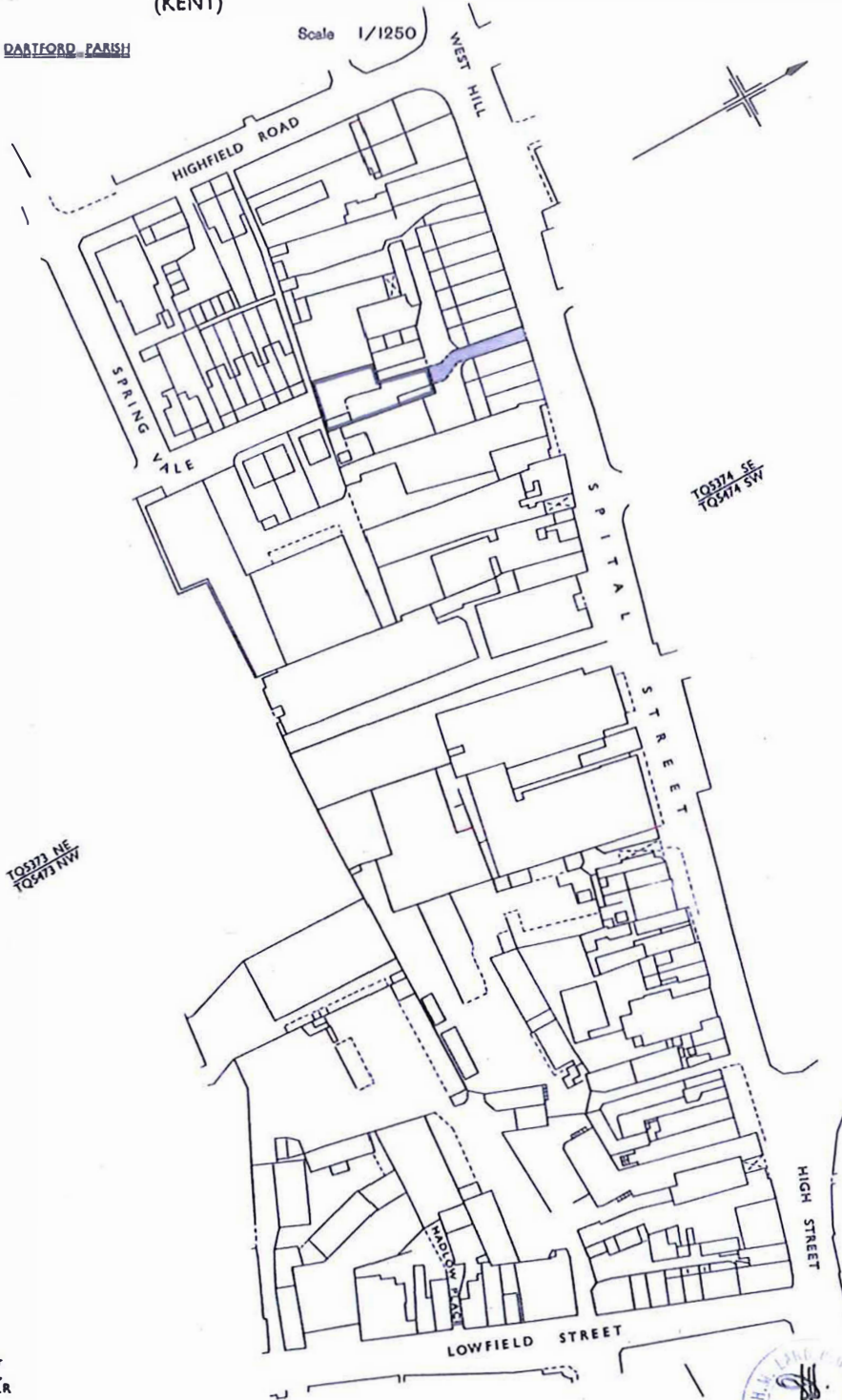

Made and printed by the Director  
General of the Ordnance Survey,  
Chasington, Surrey. 1961 for HMLR  
© Crown Copyright 1961

Filed Plan of Title No. **K 251452**



REAR OF 60-62  
SPITAL STREET  
DARTFORD

This is a copy of the title plan on 18 OCT 2016 at 15:13:01. This copy does not take account of any application made after that time even if still pending in the Land Registry when this copy was issued.

This copy is not an 'Official Copy' of the title plan. An official copy of the title plan is admissible in evidence in a court to the same extent as the original. A person is entitled to be indemnified by the registrar if he or she suffers loss by reason of a mistake in an official copy. If you want to obtain an official copy, the Land Registry web site explains how to do this.

The Land Registry endeavours to maintain high quality and scale accuracy of title plan images. The quality and accuracy of any print will depend on your printer, your computer and its print settings. This title plan shows the general position, not the exact line, of the boundaries. It may be subject to distortions in scale. Measurements scaled from this plan may not match measurements between the same points on the ground.

This title is dealt with by Land Registry, Nottingham Office.

© Crown Copyright. Produced by Land Registry. Further reproduction in whole or in part is prohibited without the prior written permission of Ordnance Survey. Licence Number 100026316.